

PRODUCT SPECIFICATIONS FOR ALL OCI ACCESS DOORS

SINGLE DOOR MODELS:
OCI-AD20X17
OCI-AD20X24

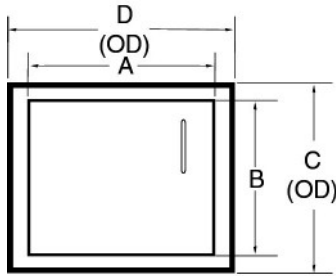

*SEE TABLE BELOW RIGHT FOR DIMENSIONS ACCORDING TO MODEL

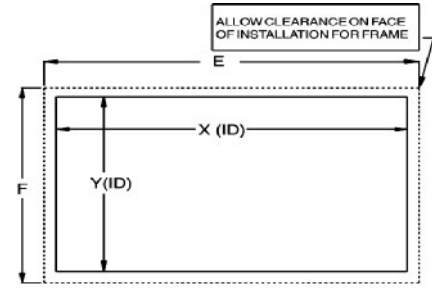

*SEE TABLE BELOW FOR DIMENSIONS ACCORDING TO MODEL

DOUBLE DOOR MODELS:
OCI-AD18X24
OCI-AD20X26
OCI-AD20X27
OCI-AD20X32
OCI-AD20X36
OCI-AD20X41
OCI-AD20X48

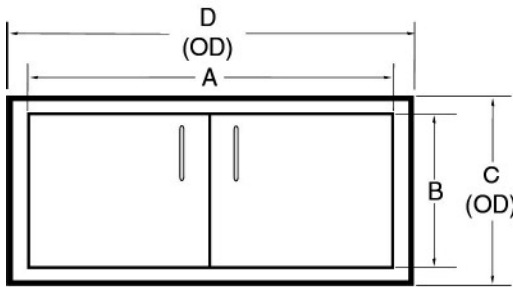

*SEE TABLE AT RIGHT FOR DIMENSIONS ACCORDING TO MODEL

ACCESS DOOR MODELS	PRODUCT DIMENSIONS				CUTOUT DIMENSIONS		FRAME CLEARANCE DIMENSIONS	
	A	B	C	D	X	Y	E	F
OCI-AD20X17	15"	19"	21 3/4"	17 7/8"	15 3/4"	20"	17 7/8"	21 3/4"
OCI-AD20X24	21 3/8"	19 3/4"	21 3/4"	24"	22"	20"	24"	21 3/4"
OCI-AD18X24	24 1/8"	18 1/8"	20 1/8"	26"	24 3/8"	18 3/8"	26"	20 1/8"
OCI-AD20X26	25 1/4"	19"	21 3/4"	28"	25 7/8"	20"	28"	21 3/4"
OCI-AD20X27	24 3/8"	19 3/4"	21 3/4"	27"	25"	20"	27"	21 3/4"
OCI-AD20X32	24 3/8"	19"	21 3/4"	32 3/4"	30 5/8"	20"	32 3/4"	21 3/4"
OCI-AD20X36	33 3/8"	19 3/4"	21 3/4"	36"	34"	20"	36"	21 3/4"
OCI-AD20X41	39 1/2"	19"	21 3/4"	42 1/4"	40 1/8"	20"	42 1/4"	21 3/4"
OCI-AD20X48	45 3/8"	19 3/4"	21 3/4"	48"	46"	20"	48"	21 3/4"

Standard Features

- 304 Non-rusting and Non-magnetic stainless steel construction.
- High Quality cabinet hinges for easy operation.
- Rubber bumper for positive stop.
- Door shelf for storage
- Easy installation.
- High quality SS hardware.
- Fully Assembled.

Warranty

- 1-Year Full replacement Warranty on all components due to manufacturer defects in craftsmanship.
- 5-Year Warranty on all Stainless Steel Parts.

Stainless Steel doors are covered for 1 full year from date of purchase, and 5 full years on all stainless steel parts only by defects in workmanship. A copy of the original receipt is required for all warranty claims. Please keep a copy of this handout along with original receipt for your files.

PLEASE NOTE:

*Because of continuing product improvement these specifications are subject to change without notice.